

### frogIn5-AC

Multifunctional 5-channel input to query buttons/switches/ other sensors (110-240 V~) and for controlling all components within the frogblue Bluetooth LE network. Featuring integrated logic module with comfort and timer functions.



#### Technical Data

##### Category

Article designation	frogIn5-AC
Article number	I5-AC.01
Assembly type	Recess-mounted (in device socket according to DIN 49073)

##### Functions and power

Inputs	5 (AC 110–240 V ~)
Outputs	–
Outputs can be dimmed	–
Minimum load	–
Maximum Power	–
Suitable loads	–
Unsuitable loads	–
Output modes	–
Protection category	Conforms to IP20 VDE Test Mark Certifications
Integrated logic module	Yes
Integrated configuration backup	Yes
Comfort and timer functions	Yes
Power measurement	–
Short circuit detection and notification	–

### frogIn5-AC

#### Dimensions and weight

Dimensions (L x B x H): 53 x 48 x 21 mm  
Weight: 25 g

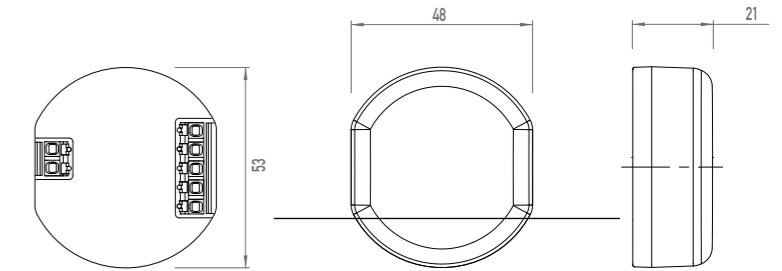

#### Connection example:

**Socket depth** min. 53 mm for installation behind switch insert  
rec. 63 mm for installation behind switch insert

Individual installation is necessary for shallow depths.

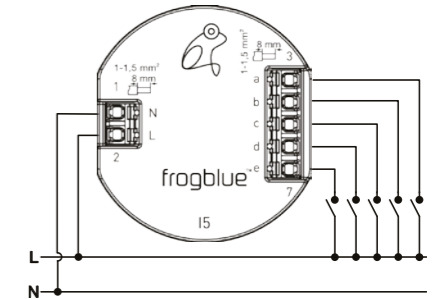

#### Electricity supply

Mains voltage	AC 110–240 V ~
Mains frequency	50 / 60 Hz
Stand-by consumption	< 130 mW

#### Network

WLAN	No
Bluetooth	Bluetooth 4.2 Low Energy
Frequency range	2400–2483.5 MHz maximum 3.4dBm
Typical radio open field range	30 metres

#### Operation and storage

Ambient temperature	-25° to +65 °C
Storage temperature	-25 ° to +70 °C
Air humidity (during operation)	(Non-condensing)

#### Power connection

Type of contact	–
Connection variants	for buttons, switches
Connection type	Spring-type terminal (single wire)
Wire cross section	1–1.5 mm <sup>2</sup> (rigid conductor recommended)
Stripping length	8 mm

#### Packaging

Packaging size	1 unit
EAN 1 unit	4260578530040
Packaging dimensions (L x W x H) 1 unit	75 x 30 x 75 mm
Weight including packaging 1 unit	42 g

frogblue\_Data\_EN\_1-21\_I5-AC.01 01.21

Subject to change.  
Electrical equipment may be installed and fitted only by qualified electricians.

Further information  
[www.frogblue.com](http://www.frogblue.com).

