

## Plug230-1-0 SU-Plug230-1-0.01

### Flush-mounted power supply unit, e.g. for frog55/frog81

#### Intended use

Power supply unit with 110–240 V~ power supply with one switching output (110–240 V~/max. 6 A) for installing in a flush-mounted socket behind frogblue products with frogPlug interface (24 V = / max. 5 W), e.g. frog55-Touch.

Installation in a device socket in accordance with DIN 49073. (Socket depth min. 53 mm for installation behind switch insert; for smaller depths, individual installation is necessary.) Suitable installation frame supplied with the respective add-on module, e.g. frog55/frog81.

#### Safety instructions

Installation and assembly of electrical devices may only be carried out by qualified electricians.

Non-observance of the instructions may cause damage to the device, fire or other hazards!

Risk of electric shock. Before working on the device or before replacing lamps, disconnect the mains voltage and switch off the circuit breaker.

Country-specific regulations must be observed.

These instructions are part of the product and must remain with the customer.

#### Device configuration

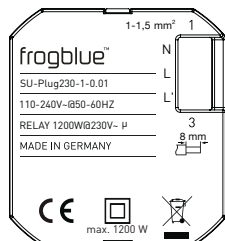

L/N: Mains cable connection  
L': Load output

#### Function

##### System information

This device is a frogblue system product. Detailed expertise gained from frogblue training is required.

The function of the device depends on the software. Detailed information about software versions and the respective scope of functions can be found on the frogblue website.

Technical descriptions, more detailed instructions and information on proper disposal are contained in the manual, which is available on the frogblue website. Start-up and configuration are carried out with the frogblue app.

#### Product features:

- 1 switching output
- Power supply unit with frogPlug interface
- Supply via mains cable; no additional cabling between the frogblue modules necessary

#### Information for qualified electricians

##### Installation and electrical connection



#### DANGER!

Electric shock from touching live parts.

Electric shock can be fatal.

**Before working on the device, disconnect it from the mains and cover any live parts in the vicinity.**

##### Connecting the device

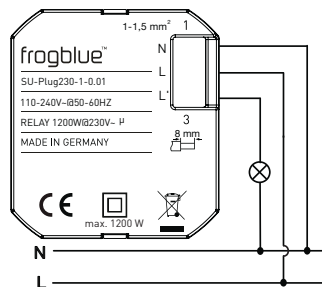

##### Stripping length



Ø 1 to 1.5 mm²; rigid conductor recommended

##### Connecting wires

Fully push the conductor into the terminal.

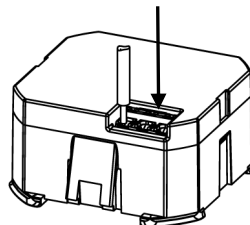

##### Installing the device

Mount the frame on the flush-mounted socket using the screws supplied with the selected add-on module (frog55/frog81).

Push Plug230 in the pre-assembled frame until there is an audible click.

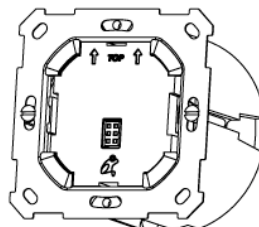

Attach the enclosed connector to the frogPlug before mounting the required add-on device (e.g. frog55/frog81).

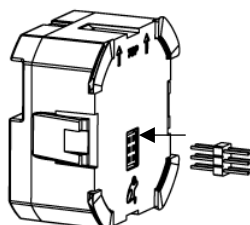

#### Removing the device

If necessary, remove the add-on device from the frame or pin strip.

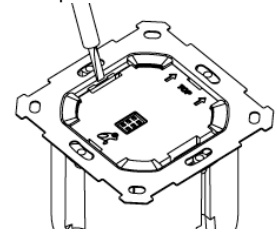

Removal from frame: using a screwdriver, release the frogPlug both sides from the frame.

##### Disconnecting wires

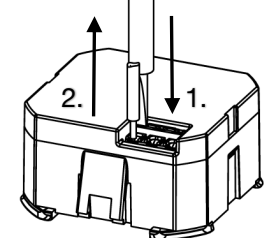

1. Press and hold release with a slotted screwdriver (size 3).
2. Remove the wires.  
*Repeat the process for each wire.*

#### Technical data

Mains voltage 110–240 V AC~  
Power frequency 50/60 Hz

Ambient temperature -25 to +55 °C  
Storage/transportation temperature -25 to +70 °C

Outputs 1; 110–240 V~  
50/60 Hz

Contact type µ, N/O contact

Suitable loads Incandescent lamp load  
Electronic transformer  
Inductive load

Connected load of relay  
1200 W/1200 VA (220–240 V~)  
600 W/600 VA (110–140 V~)

Dimensions (L x W x H) 51 x 50 x 27 mm  
Connection type Spring terminal  
Conductor cross-section 1 to 1.5 mm²

Plug interface: SELV

Subject to technical changes.

#### Warranty

The warranty is provided by specialist dealers within the framework of the statutory provisions.

#### Declaration of Conformity

frogblue AG, Luxemburger 6, 67657 Kaiserslautern, Germany, hereby declares that this product complies with the fundamental requirements and other relevant conditions of the Directives.

2014/53/EU RED Directive  
2011/65/EU RoHS Directive

A copy of the Declaration of Conformity is available at: [www.frogblue.com](http://www.frogblue.com)